

# CONCEPT

VOL. 129

International Magazine of Competition CA 1104 January 2019



**DOSHIIN Architecture** Architects Concept

**Masterplan of the Beijing River Creative Zone** UNStudio

**Rotterdam Market Hall** MVRDV

**Unilever Headquarters** Behnisch Architekten

**National Institute of Nakdong River Biological Resources**



ISSN 1386-4262



**VDAB Office Building** Niklaas, Belgium  
BOB361 Architects

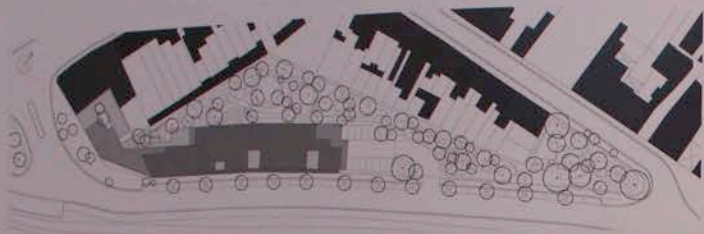

Site Plan



■ Basic Concept

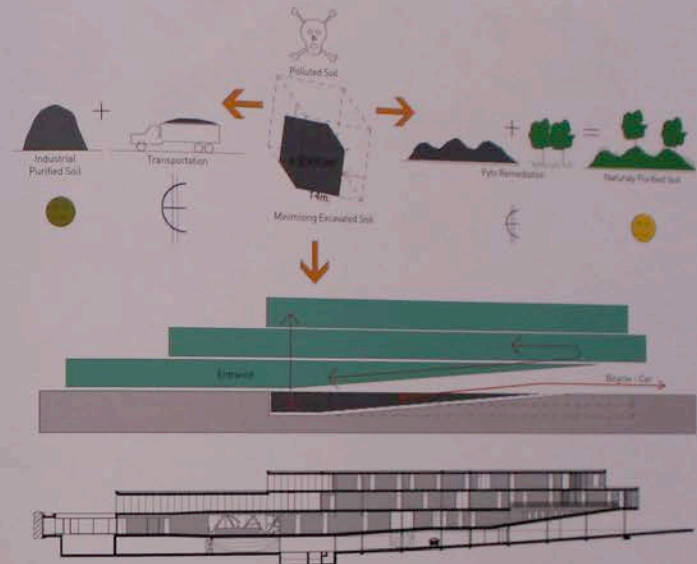

Transverse Section





### Urban Anchoring - Corners

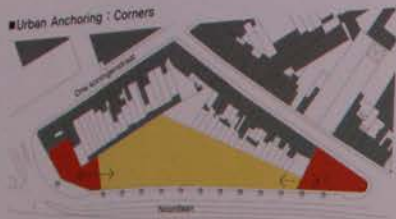

1. Autonomous North Building  
Close Link with The Site  
Relation with and Face to Main Public Spaces  
Connected with The Main Road  
Regular Meeting Point - Place of Conflict  
Large Protrusion Creating Space
2. Autonomous Building (1420m<sup>2</sup>)  
Difficult Link with The Rest of The Site  
Relation with and Face to Main Public Functions  
Connected with a Main Private Road  
Relation with Secondary Access (Nette - Railway Station)

### Implementation in The Urban Building Block

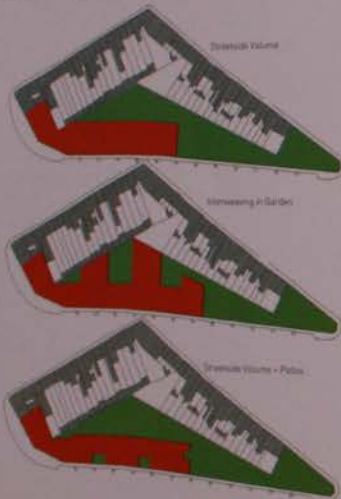

<ul style="list-style-type: none"> <li>• Compactness</li> <li>• Economy</li> <li>• Acoustics Offices Towards The Garden</li> <li>• Orientation Offices Towards The Street</li> <li>• Orientation Offices Towards The Garden</li> <li>• Distance to Housing</li> <li>• No Fragmentation of The Garden</li> </ul>	<ul style="list-style-type: none"> <li>• Acoustics Office Towards The Street and Towards The Railway</li> </ul>
<ul style="list-style-type: none"> <li>• Acoustics   All Office Towards Garden</li> </ul>	<ul style="list-style-type: none"> <li>• Compactness</li> <li>• Economy</li> <li>• Distance to Housing</li> <li>• Fragmentation of The Garden</li> </ul>
<ul style="list-style-type: none"> <li>• Compactness</li> <li>• Economy</li> <li>• Acoustics Offices Towards The Garden</li> <li>• Orientation Offices Towards The Street</li> <li>• Orientation Offices Towards The Garden</li> <li>• Distance to Housing</li> <li>• No Fragmentation of The Garden</li> </ul>	

Architects BOB361 Architects - Jan Odekramp  
 Collaborators Eveline Vyncke, Maarten Deconock, Gunther Sieghevelde, Nathan Gens,  
 Bram Aerts, Maureen Heyns  
 Structural Engineer Bureau voor Architectuur en Statistiek Dirk Jaupiet  
 Technical Engineer Bureau Bouwtechniek  
 Building Physics Danelas Pružs Bouwtechnisch Ingenieursbureau  
 Landscape Architect Alarik Heirman  
 Client Vlaamse Dienst voor Arbeidsbemiddeling en Beroepsopleiding  
 Bldg. Area Offices - 3,838m<sup>2</sup>, Surface Parking Space - 422m<sup>2</sup>  
 Photo by André Nulleke, Jan Kampmeiers & Frederik Verschyssa

### VDAB 오피스

건축물은 벨기에 리콜라스 지역에 위치하는 VDAB사원의 사무실이다. 건물 구성에는 이사진 및 직원들을 위한 사무공간이 위치하며, 꼭대기에 회의실이 있다. 수직 계단 옆으로 난 자투리 공간은 직원들의 휴게공간으로 이용된다. 1층은 공용공간으로 리셉션 홀과 리셉션 홀 바로 위는 작은 주방, 흡연구역 및 회의실을 갖춘 공간이 있으며, 재무와 공동 서비스를 담당하는 사무실이 중앙에 자리 잡고 있다. 내부를 들어서면 평행한 벽으로 만들어진 복도가 나타나고, 콘크리트 바닥으로 구성된 마루가 있다. 그러므로 층의 높이 혹은 고층주 리프트, 키오스크와 연결되어 있는 중앙 관리 구역, 공용인 리프트 등 고가치 기본 기능들로 채워진다. 건축물 왼쪽 날개 부분 사무실들은 중앙의 안을 주변으로 형성되어 있다. 그리고 직원 서비스 및 관리 지원 시설은 공사를 따라 배치되어 있다.

The building is office of VDAB company in Nikaas, Belgium. On the second floor, functions that receive a lesser public audience are concentrated. These functions include offices for the Executive Board,

staff services.

A general meeting room forms the head of the building. The space next to the vertical staircase, can be used as individual conversation areas, for all staff members.

On the first floor, a number of common functions are settled. Directly above the reception hall, the cafeteria that includes a small kitchen, a smoking lounge, and a meeting room. The financial and facility services offices are situated, centrally in the building.

The lobby hall on the ground floor, regroups the three basic functions: firstly, the employer line, secondly the central administrative cell, which is linked with the counter and thirdly the employee line.

The offices in the left wing of the building are organised around a central patio and the staff services and administrative support facilities have been situated along the slope.

Written by BOB361 Architects

### Materialization

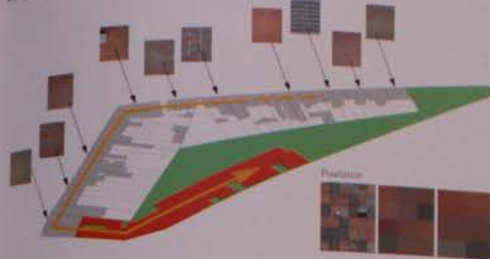

### Flexibility - Polyvalence

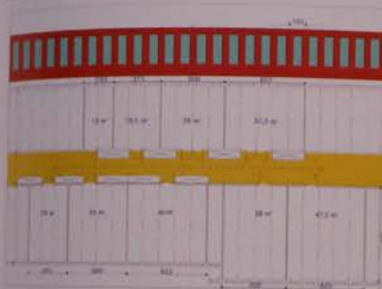





Level 1



Level 2